



PowerCore™ Filtration Technology Delivers Improved Filtration Performance

Greater efficiency

The straight-through fluted design of PowerCore Filtration Technology is three times more efficient than average conventional pleated filters

Engine protection

No media movement, expansion, contraction or bunching, with less dust and dirt passed on to the engine

Contaminant encapsulation

Dust and dirt won't dislodge during servicing

Simple Maintenance

Lighter and smaller, changing filters is a snap and they are metal-free

Built-in service handle is attached directly to the filter



Design Differentiation

The design of the U.S. and internationally patented housings, filters and filter media are key to Donaldson® PowerCore Filtration Technology (additional patents pending).

Donaldson has been manufacturing air cleaners with PowerCore Filtration Technology since 1999. There are over 1,800,000 units installed on various types of equipment throughout the world.

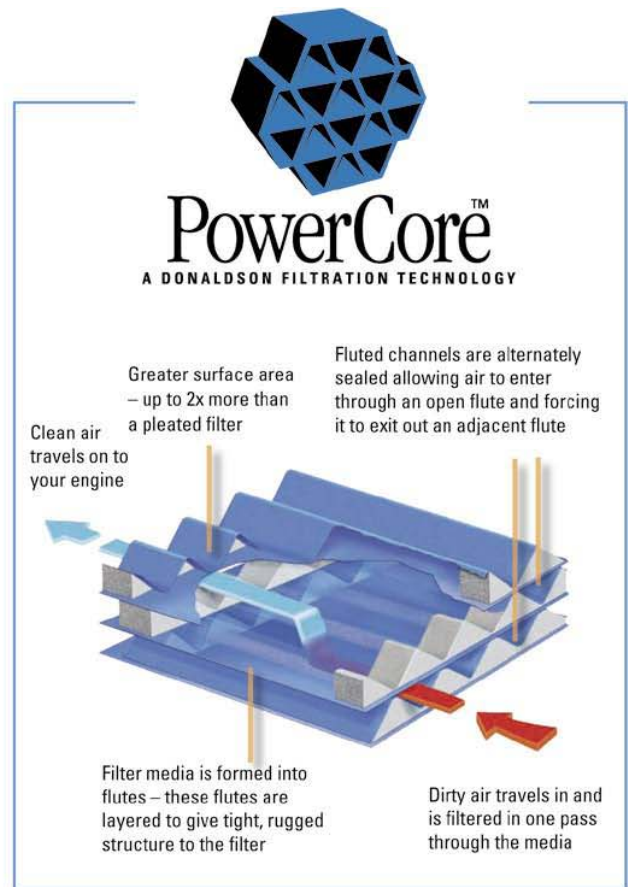

Dust Holding Capacity

Gain over 100% more dust holding capacity in a given volume.

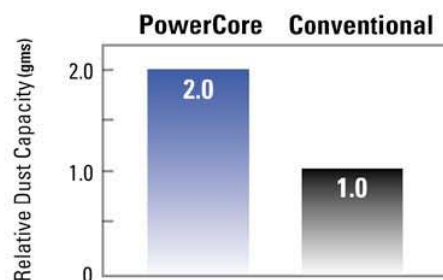

Overall Efficiency

Improved filtration efficiency.

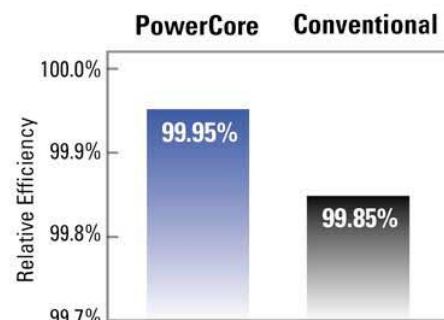

Service Access on Inlet End - PSD08

Exploded view is of D080020. For tube on long side of inlet end (opposite clamps), consider D080026.

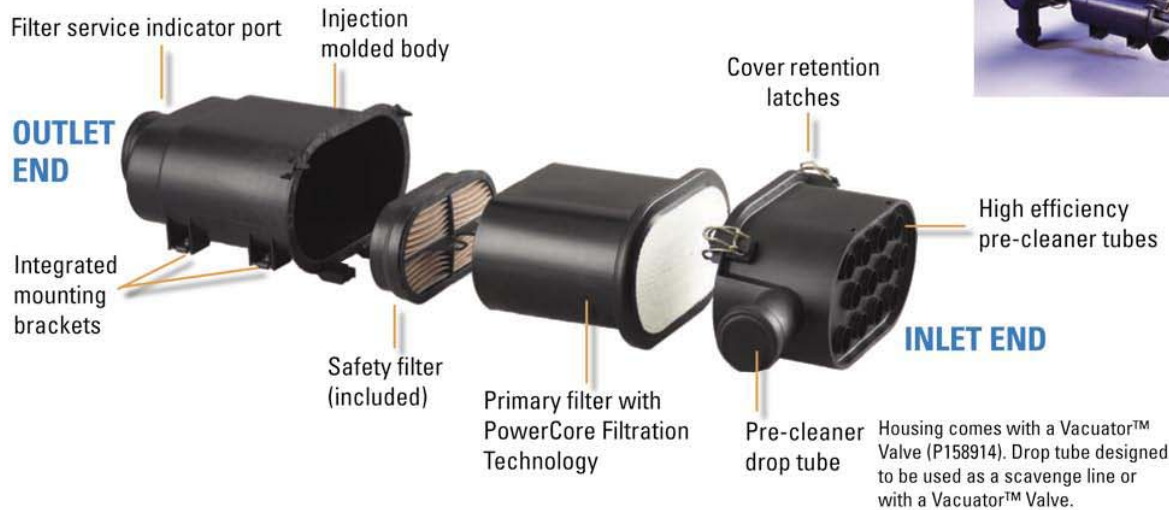

This design offers the greatest amount of installation flexibility for equipment manufacturers.

Service Access on Side - PSD09

Exploded view is of D090019 model. For tube on long side of inlet end, consider D090020 or D090022.

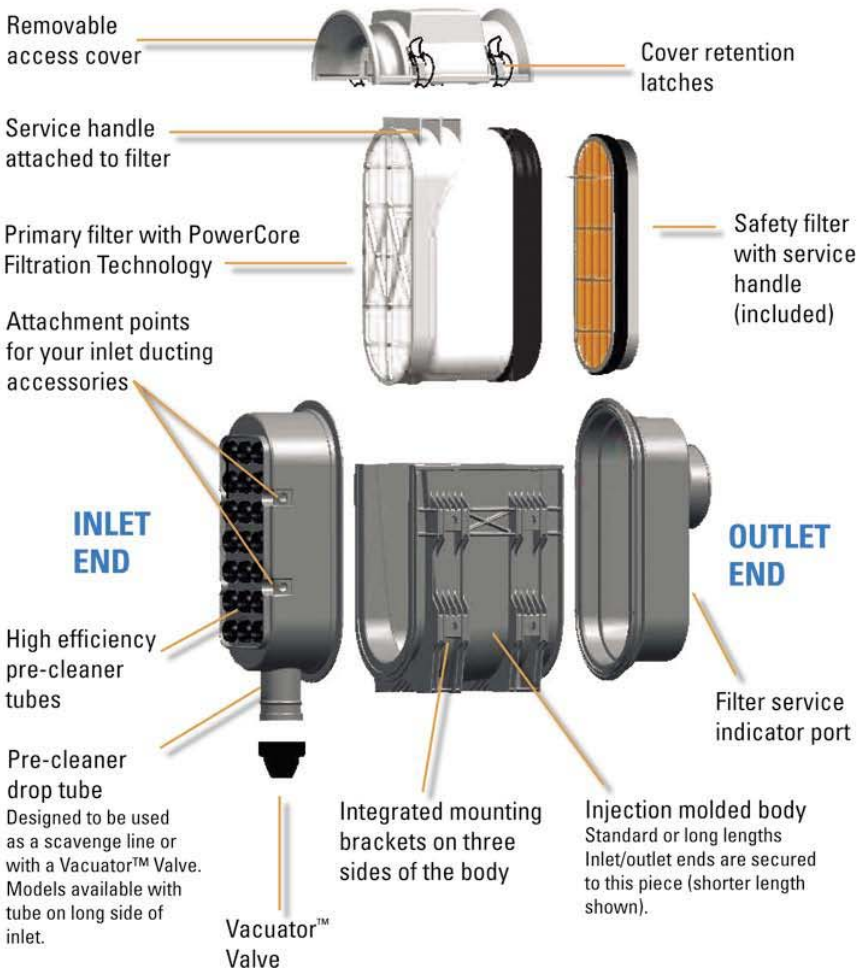

Service Access on Inlet End



D080026

Assembly
Weight
2.2 kg.
4.8 lbs.



D080020

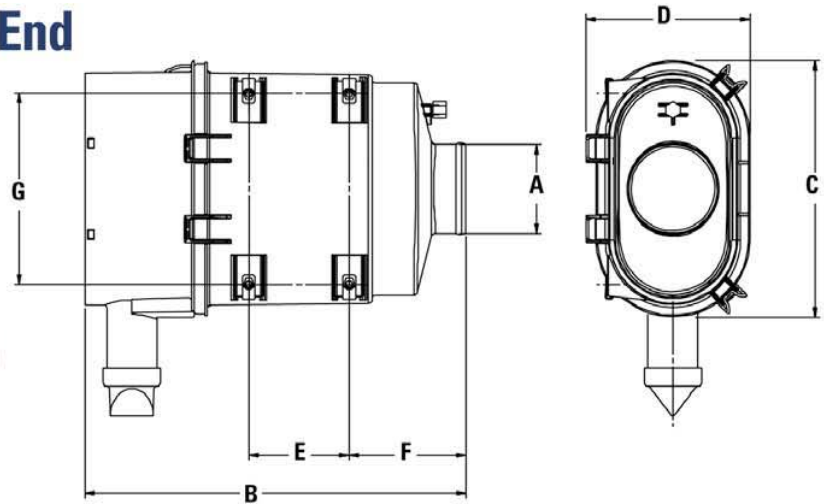

Airflow Range (cfm)			Housing Part No.	A		B		C		D		E		F		G	
Low	Mid	High		mm	in.	mm	in.	mm	in.	mm	in.	mm	in.	mm	in.	mm	in.
176 cfm @ 6" H ₂ O	206 cfm @ 8" H ₂ O	232 cfm @ 10" H ₂ O	D080020 Horizontal	89	3.50	380	14.97	256	10.07	154	6.05	100	3.94	117	4.59	191	7.50
			D080026 Vertical														

PSD08 Service Parts: Primary Air Filter - P608533; Safety Filter - P600975; and Vacuator™ Valve - P158914

Service Access on Side



D090020 - Horizontal

Assembly
Weight
3.6 kg.
7.8 lbs.



D090019 - Vertical

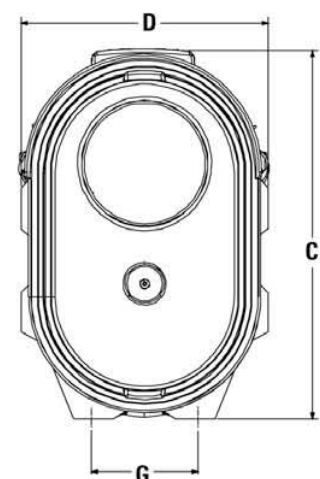
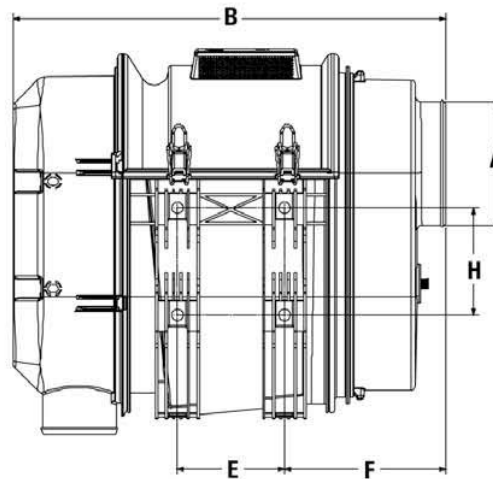

Airflow Range			Housing Part No.	A		B		C		D		E		F		G		H											
Low	Mid	High		mm	in.	mm	in.	mm	in.	mm	in.	mm	in.	mm	in.	mm	in.	mm	in.										
255 cfm @ 6" H ₂ O	300 cfm @ 8" H ₂ O	340 cfm @ 10" H ₂ O	D090019 Vertical	102	4.00	432	17.00	363	14.31	180	7.09	110	4.33	173	6.83	100	3.94	130	5.12										
			D090020 Horizontal																										
	320 cfm @ 9" H ₂ O	370 cfm @ 12" H ₂ O	D090021 Vertical			532	20.96					132	5.20																
			D090022 Horizontal																										

Service Parts: D090019/D090020 Assembly - Primary Air Filter - P608665; Safety Filter - P606121; and Vacuator™ Valve - P158914
D090021/D090022 Assembly - Primary Air Filter - P608675; Safety Filter - P606121; and Vacuator™ Valve - P158914