

Full-View Pre-Cleaner Helps Extend Filter Life on Agricultural & Construction Equipment

Features

- Recommended mounting: on top of the engine intake stack
- Centrifugal force in bowl separates up to 75% of incoming dust **before** it enters the engine air intake system
- Low maintenance
- Durable, lightweight, noncorrosive construction
- Full-view plastic bowl lets operator easily see when service is needed
- One-bolt cover retention for easy service. When dirt reaches the level of the arrow, remove top nut and plastic body, then empty — no tools required
- Mounting clamp included



Tired of Emptying the Cup?

Before you consider replacing your full-view pre-cleaner with another one, check out the TopSpin™ and TopSpin™ HD models on the previous pages.



Pre-cleaner Upgrade Path

| Full-View | TopSpin | TopSpin™ HD |
|--------------|--------------|-------------|
| H000820..... | H002425 | |
| H000821..... | H002426 | |
| H000858..... | H002394..... | H002853 |
| H000823..... | H002427 | |
| H001250..... | H002435 | |
| H001251..... | H002436..... | H002851 |
| H001249..... | H002437..... | H002852 |
| H001823..... | H002434..... | H002850 |
| H002043..... | H002433..... | H002854 |
| H002044..... | H002432 | |
| H002045..... | H002431 | |
| H002223..... | H002438..... | H002855 |
| H002224..... | H002439..... | H002856 |
| N/A | N/A | H002857 |

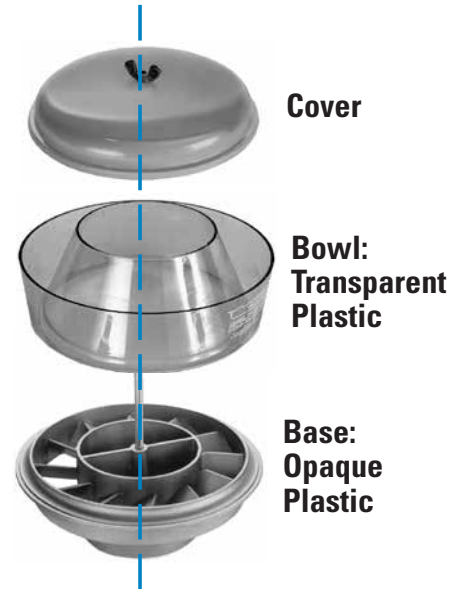
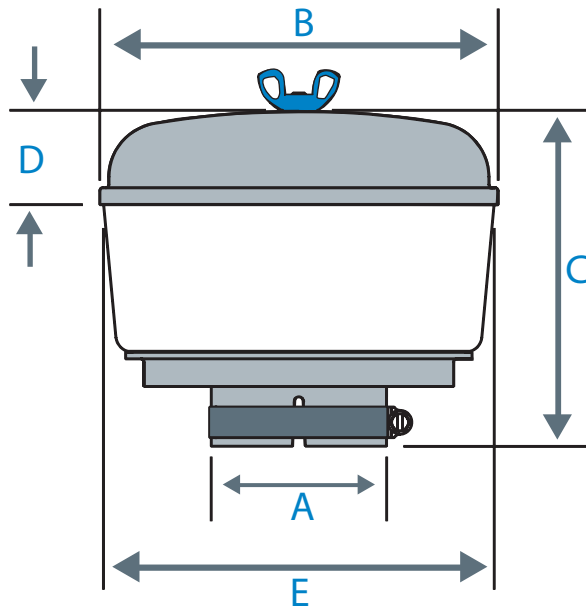

Full-View Pre-Cleaners Specifications

| Inlet (ID/OD) | | B | | C | | D | | E | | Weight | | Entire F.V. Pre-Cleaner | Replacement | | Max. Airflow CFM |
|---------------|-----|-------|-----|-------|-----|------|----|-------|-----|--------|------|-------------------------|-------------|---------|------------------|
| A | | | | | | | | | | lbs | kg | | Cover | Bowl | |
| in | mm | in | mm | in | mm | in | mm | in | mm | | | | | | |
| 1.75 | 44 | 5.59 | 142 | 4.75 | 121 | 1.72 | 44 | 5.50 | 140 | 0.8 | 0.37 | H002042 | P020116 | P020115 | 80 |
| 2.00 | 51 | 5.59 | 142 | 4.75 | 121 | 1.72 | 44 | 5.50 | 140 | 0.9 | 0.41 | H002040 | P020116 | P020115 | 90 |
| | | 7.34 | 186 | 6.19 | 157 | 1.72 | 44 | 7.25 | 184 | 1.4 | 0.64 | H001823 ¹ | P020648 | P020227 | 110 |
| 2.25 | 57 | 7.34 | 186 | 6.19 | 157 | 1.72 | 44 | 7.25 | 184 | 1.5 | 0.68 | H001250 | P020648 | P020227 | 130 |
| 2.50 | 64 | 7.34 | 186 | 6.19 | 157 | 1.72 | 44 | 7.25 | 184 | 1.5 | 0.68 | H001251 | P020648 | P020227 | 150 |
| 3.00 | 76 | 7.34 | 186 | 6.19 | 157 | 1.72 | 44 | 7.25 | 184 | 1.6 | 0.73 | H001249 | P020648 | P020227 | 170 |
| | | 10.63 | 270 | 7.66 | 195 | 1.84 | 47 | 10.50 | 267 | 3.4 | 1.54 | H000820 ¹ | P016548 | P016330 | 320 |
| 3.75 | 95 | 10.63 | 270 | 7.66 | 195 | 1.84 | 47 | 10.50 | 267 | 3.4 | 1.54 | H000821 | P016548 | P016330 | 330 |
| 4.00 | 102 | 10.63 | 270 | 7.66 | 195 | 1.84 | 47 | 10.50 | 267 | 3.4 | 1.54 | H000858 | P016548 | P016330 | 340 |
| | | 12.06 | 306 | 8.19 | 208 | 2.00 | 51 | 11.94 | 303 | 4.5 | 2.04 | H002045 ¹ | P020345 | P020344 | 660 |
| 4.50 | 114 | 10.63 | 270 | 7.66 | 195 | 1.84 | 47 | 10.50 | 267 | 3.4 | 1.54 | H000823 | P016548 | P016330 | 340 |
| | | 12.06 | 306 | 8.19 | 208 | 2.00 | 51 | 11.94 | 303 | 4.5 | 2.04 | H002044 ¹ | P020345 | P020344 | 700 |
| 5.00 | 127 | 12.06 | 306 | 7.69 | 195 | 2.00 | 51 | 11.94 | 303 | 4.5 | 2.04 | H002043 | P020345 | P020344 | 740 |
| 6.00 | 152 | 16.25 | 413 | 10.00 | 254 | 2.81 | 71 | 15.94 | 405 | 9.2 | 4.17 | H002223 | P104691 | P158324 | 1300 |
| 7.00 | 178 | 16.25 | 413 | 10.00 | 254 | 2.81 | 71 | 15.94 | 405 | 9.2 | 4.17 | H002224 | P104691 | P158324 | 1500 |

1 - Heavy Duty Option