

**500FG Replacement Parts**

<u>Part Number</u>	<u>Description</u>
1 <b>RK15378</b> <b>RK11838</b>	Mounting Bracket Kit Bracket Hardware Kit (5/16"-18, not shown)
2 <b>RK15377-01</b> <b>RK15377-02</b>	Body Kit (3/4"-16 UNF Ports) Body Kit (16M X 1.5 Ports)
3 <b>RK15035</b>	Bowl Ring Kit
4 <b>RK15081</b>	Hex Head Capscrews Kit (Includes 4, 10-24 x 7/8")
5 <b>RK15405</b>	See-thru Bowl Kit (Includes bowl, drain, bowl gasket and probe plug)
<b>RK15301</b>	Metal Bowl Kit (not shown) (Includes 1/4" NPT Drain)
6 <b>RK11-1945</b> <b>11350</b>	T-handle and O-ring Kit (9/16"-18 UNF Threads) T-handle O-ring
7 <b>RK15078</b> <b>15005</b>	Lid and Lid Gasket Kit Lid Gasket
8 <b>RK15397</b>	Return Tube Kit
9 (All replacement elements include seals) <b>2010SM-OR</b> <b>2010TM-OR</b> <b>2010PM-OR</b>	2 Micron Element 10 Micron Element 30 Micron Element
10 (Heater kits include item #11) <b>RK15383-01</b> <sup>1</sup> <b>RK15383-02</b> <sup>1</sup>	Heater Kit (12 vdc, 150 watt) Heater Kit (24 vdc, 150 watt)
11 <b>RK21067</b> <b>RK11-1679</b>	Feed-thru Assy Kit (for heater) Feed-thru Plug Kit (not shown)
12 <b>15374</b>	Bowl Gasket
13 <b>RK15010B</b>	Check Ball with Seal Kit
14 <b>RK15013D</b>	Centrifuge/Conical Baffle Kit
15 <b>RK20126</b>	Water Probe Port Plug Kit
16 <b>RK21069</b> <sup>2</sup>	Water Sensor Probe Kit

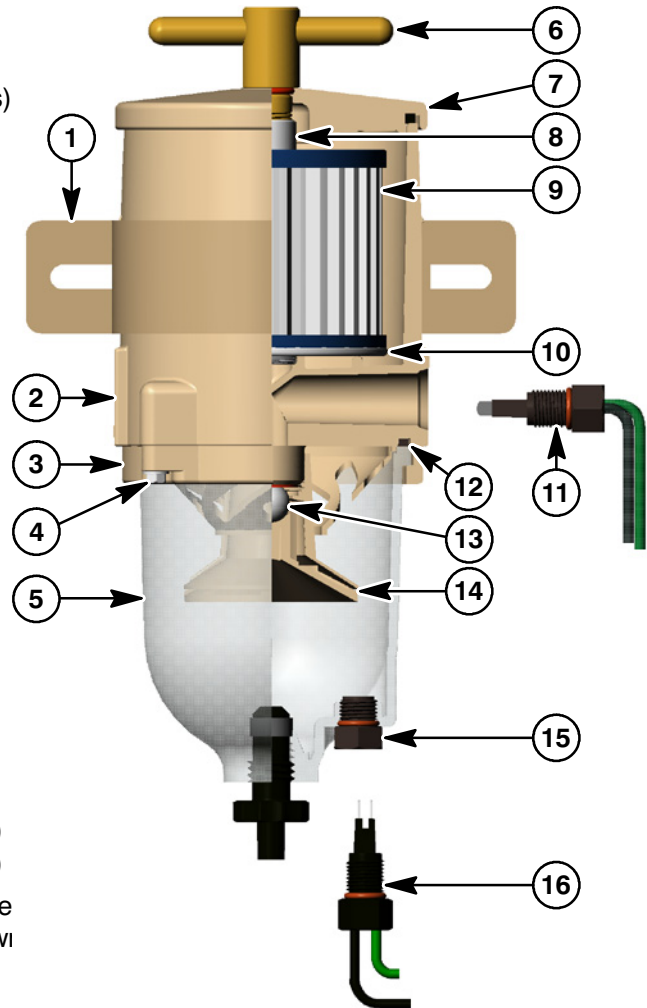

Additional Parts (not shown)

<b>RK15211</b>	Complete Seal Service Kit
----------------	---------------------------

Notes:

<sup>1</sup> In-filter heater kits require a Heater Relay Kit - see Accessories section of this catalog. Maximum power requirements for in-filter heaters are: 12.5 amps for 12 vdc and 6.3 amps for 24 vdc.

<sup>2</sup> Water probe must be used with Water Detection Kit - see Accessories section of this catalog.

## 900FH Replacement Parts

Part Number	Description
1 <b>RK11-1945</b>	T-handle and O-ring Kit (9/16"-18 UNF Threads)
<b>11350</b>	T-handle O-ring (not shown)
2 <b>RK11-1927-01</b>	Lid and Lid Gasket Kit
<b>11007</b>	Lid (and Bowl) Gasket
3 <b>RK19002-03</b>	Outer Cylinder Kit
4 <b>RK11-1931</b>	Return Tube Kit
5 <b>RK11815-103</b>	Mounting Bracket Kit (Includes bracket hardware)
6	(All replacement elements include seals)
<b>2040SM-OR</b>	2 Micron Element
<b>2040TM-OR</b>	10 Micron Element
<b>2040PM-OR</b>	30 Micron Element
7 <b>RK11-1953</b>	Valve, Spring & O-ring Kit
8	(Heater kits include item #9)
<b>RK11-1800-01<sup>1</sup></b>	Heater Kit (12 vdc, 300 watt)
<b>RK11-1800-02<sup>1</sup></b>	Heater Kit (24 vdc, 300 watt)
9 <b>RK21067</b>	Feed-thru Assy Kit (for heater)
<b>RK11-1679</b>	Feed-thru Plug Kit (not shown)
10 <b>11007</b>	Bowl (and Lid) Gasket
11 <b>RK11028B</b>	Check Ball with Seal Kit
12 <b>RK11-1939</b>	Centrifuge/Conical Baffle Kit
13 <b>RK32204<sup>2</sup></b>	Water Sensor Probe Kit
<b>RK22838</b>	Water Probe Port Plug Kit
14 <b>RK11-1776</b>	Body Kit (with 7/8"-14 UNF Ports)
<b>RK11-1776-02</b>	Body Kit (with 22M X 1.5 Ports)
15 <b>RK11037A</b>	Bowl Ring Kit (5" Diameter)
16 <b>RK11542</b>	Capscrew Kit (4)
17 <b>RK11-1938</b>	See-thru Bowl Kit (Includes bowl, drain, bowl gasket and probe plug)

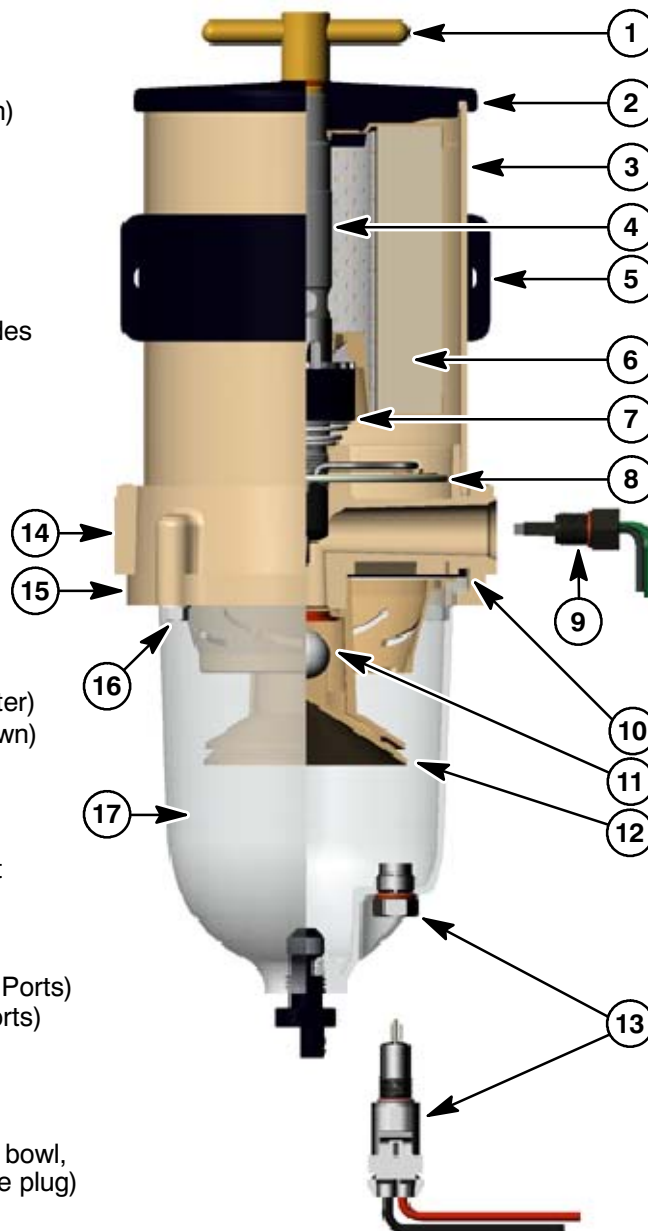

### Additional Parts (not shown)

<b>RK11-1952</b>	Complete Seal Service Kit
------------------	---------------------------

### Notes:

- <sup>1</sup> In-filter heater kits require a Heater Relay Kit - see Accessories section of this catalog. Maximum power requirements for in-filter heaters are: 25 amps for 12 vdc and 12.5 amps for 24 vdc.
- <sup>2</sup> Water probe must be used with Water Detection Kit - see Accessories section of this catalog. Water probe features a detachable harness connector.

## 1000FH Replacement Parts

Part Number	Description
1 <b>RK11-1945</b>	T-handle and O-ring Kit (9/16"-18 UNF Threads)
11350	T-handle O-ring (not shown)
2 <b>RK11-1927-01</b>	Lid and Gasket Kit
11007	Lid (and Bowl) Gasket
3 <b>RK11021-03</b>	Outer Cylinder Kit
4 <b>RK11-1930</b>	Return Tube Kit
5 <b>RK11815-103</b>	Mounting Bracket (Includes bracket hardware)
6	(All replacement elements include seals)
<b>2020SM-OR</b>	2 Micron Element
<b>2020TM-OR</b>	10 Micron Element
<b>2020PM-OR</b>	30 Micron Element
7 <b>RK11-1953</b>	Valve, Spring & O-ring Kit
8	(Heater kits include item #9)
<b>RK11-1800-01<sup>1</sup></b>	Heater (12 vdc, 300 watt)
<b>RK11-1800-02<sup>1</sup></b>	Heater (24 vdc, 300 watt)
9 <b>RK21067</b>	Feed-thru Assy (for heater)
<b>RK11-1679</b>	Feed-thru Plug (not shown)
10 11007	Bowl (and Lid) Gasket
11 <b>RK11028B</b>	Check Ball with Seal
12 <b>RK11-1939</b>	Centrifuge/Conical Baffle
13 <b>RK32204<sup>2</sup></b>	Water Sensor Probe
<b>RK22838</b>	Water Probe Port Plug
14 <b>RK11-1776</b>	Body (with 7/8"-14 UNF Ports)
<b>RK11-1776-02</b>	Body Kit (with 22M X 1.5 Ports)
15 <b>RK11037A</b>	Bowl Ring (5" Diameter)
16 <b>RK11542</b>	Capscrew Kit (4)
17 <b>RK11-1938</b>	See-thru Bowl Kit (Includes bowl, drain, bowl gasket and probe plug)

### Additional Parts (not shown)

<b>RK11-1952</b>	Complete Seal Service Kit
------------------	---------------------------

### Notes:

- <sup>1</sup> In-filter heater kits require a Heater Relay Kit - see Accessories section of this catalog. Maximum power requirements for in-filter heaters are: 25 amps for 12 vdc and 12.5 amps for 24 vdc.
- <sup>2</sup> Water probe must be used with Water Detection Kit - see Accessories section of this catalog. Water probe features a detachable harness connector.

