

Battery Operated Pump (20ltr)

Owners Manual

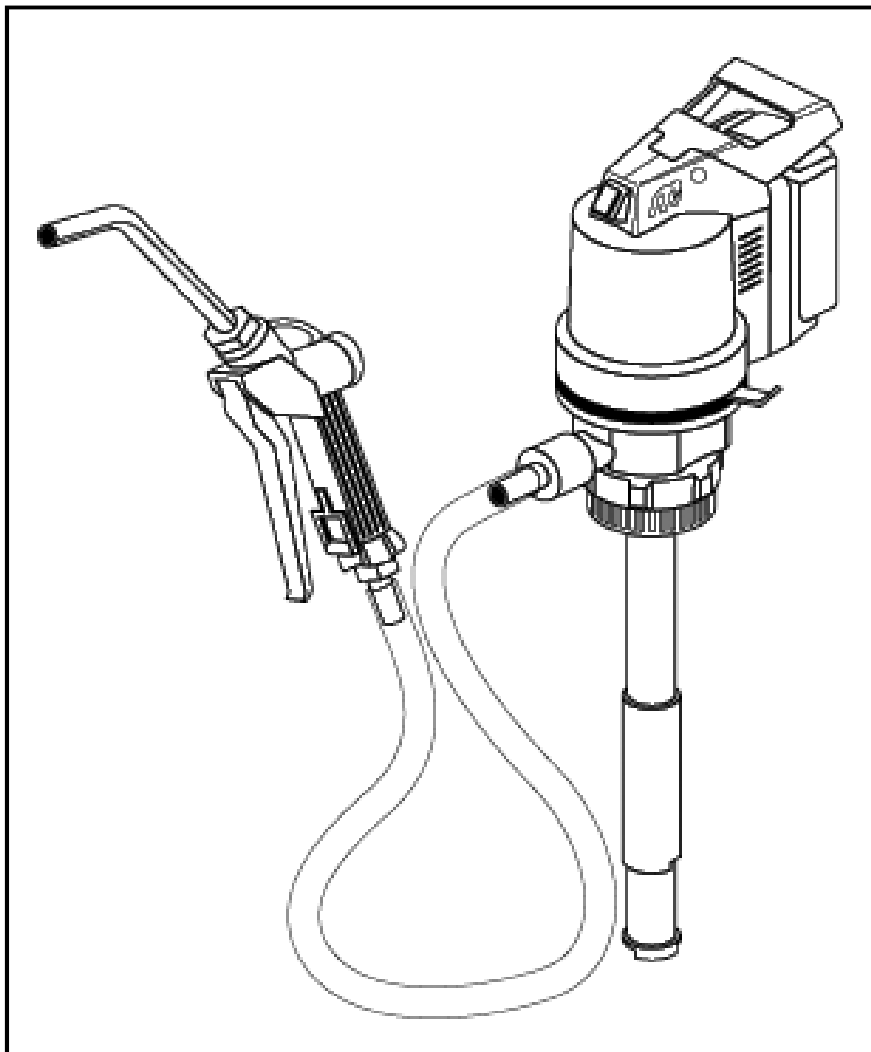

BOP20

BP-inst-issue1

INTRODUCTION

Thank you for purchasing the Macnaught BOP20 battery operated pump.

Macnaught has designed and manufactured this pump to the highest quality standards using premium quality materials and workmanship.

PLEASE READ THIS SAFETY INFORMATION CAREFULLY BEFORE USE.

Read and retain this instruction manual to assist you in the operation of your new product.



CAUTION

Please read this important information carefully before use.

This product should only be used with automotive oils and lubricants

- Visually inspect pump, charger and battery prior to use for any signs of damage, loose or missing parts. If equipment is worn or damaged, remove it from service. (Replace if required)
- The BOP20 Battery operated pump must be used strictly in accordance with Macnaught's terms and conditions.
- 'Cautions' listed throughout this manual to advise of actions which may cause damage to your equipment.

Failure to follow all instructions listed below may result in electric shock, fire, serious injury and/or damage to the power tool. The term "power tool" in all of the warnings listed refers to your battery operated (cordless) power tool.

- Make sure all operators have adequate access to the following instructions.



GENERAL SAFETY

DO NOT operate power tools in explosive areas, e.g; close to flammable liquids, gases or dust.



ELECTRICAL SAFETY

- Never modify electrical connections.
- **DO NOT** expose power tool to rain or wet conditions.
- **DO NOT** use product if the product is damaged or the switch does not turn the pump on.
- **Only use "ORIGINAL" Macnaught replacement parts, battery or charger**



BATTERY and CHARGER SAFETY

- If "battery-pack" case is damaged **DO NOT** use - Danger of electric shock or electrocution.
- Battery charger **MUST ONLY** be used for charging the rechargeable batteries supplied with the BOP20.
- **DO NOT** operate charger if charger, power cord or plug is damaged - replace immediately.
- **DO NOT** disassemble charger or battery.
- **DO NOT** store or use the power tool and battery pack in locations where the temperature may reach or exceed 40°C/104°F.
- **DO NOT** use charger on any other voltage than designated on the charger.

BATTERY DISPOSAL

NOTE: Dispose of old batteries properly. The battery contains rechargeable Lithium-ion and must be recycled or disposed of properly. Please refer to the local authorities for the correct method of battery disposal.

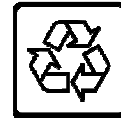

Li-ion



DO NOT incinerate the battery pack. The battery can explode in a fire

DO NOT attempt to disassemble any battery.

CHARGE BATTERY

1) Insert battery

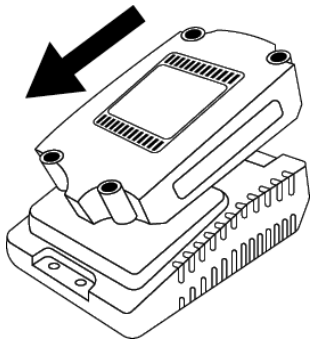

2) Power on
(green light only)

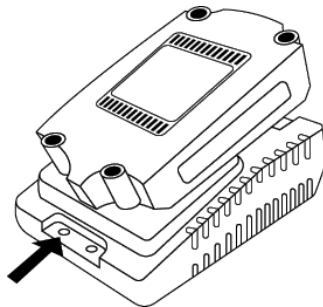

3) Battery charging
(red light only)

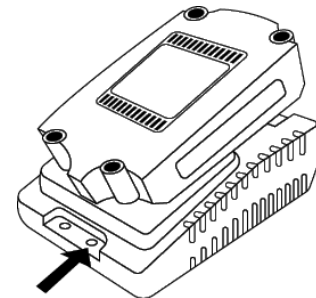

4) Battery charged
(green light only)

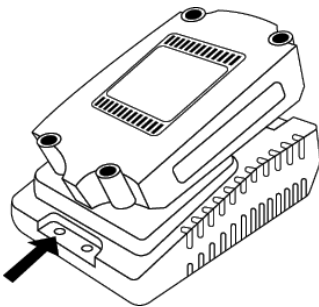

Note: Red light flashes when battery voltage is low
(trickle charging to prevent battery damage)

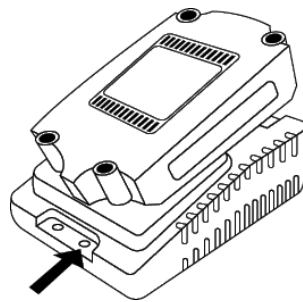

INSERT / REMOVE BATTERY

1) Insert battery
a) lift handle
b) push down

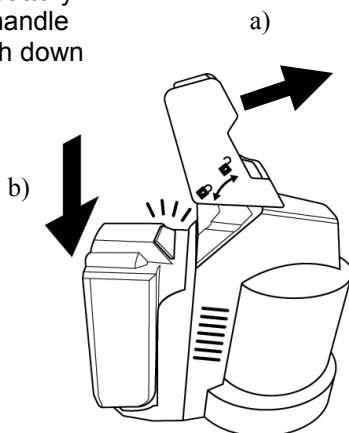

2) Remove battery
a) lift handle
b) press button
c) pull up

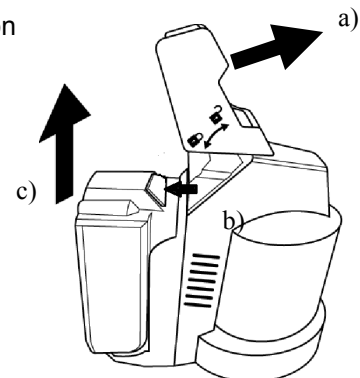

ASSEMBLY

Note: Remove both the inlet and outlet plugs from the pump stem before use.

1) Pull down extender tube

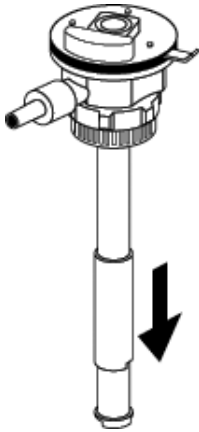

2) Push the pump stem into container

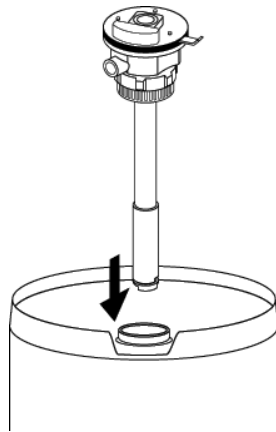

3) Tighten bung adapter to secure pump stem

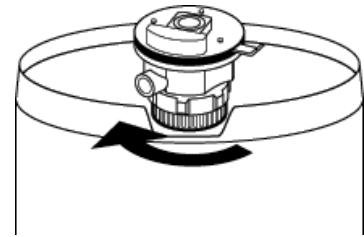

4) Attach hose and gun (ensure end gasket is in place)

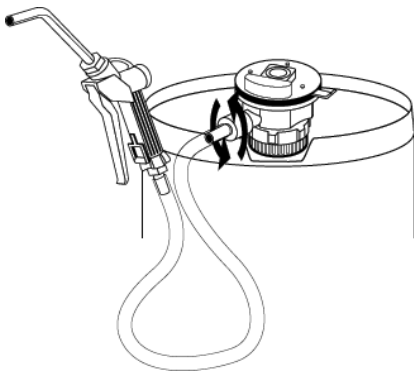

5) Ensure switch is off, then place power head onto pump stem

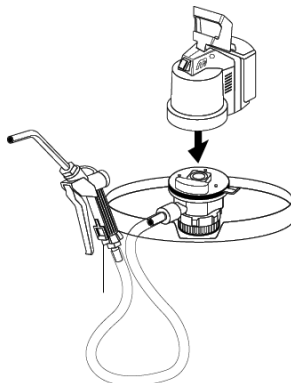

6) Press handle down to lock power head

Note: Power head will not operate unless locked correctly into position.

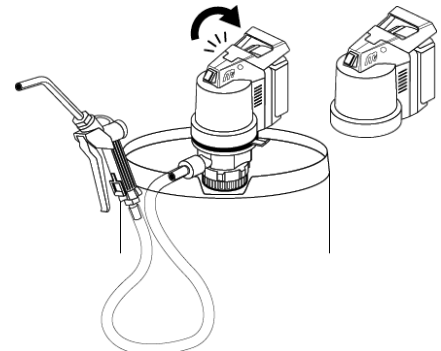

7) Place gun onto hanger when finished

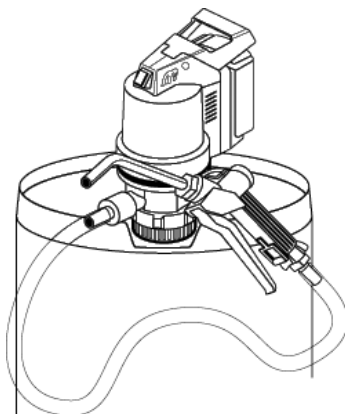

8) To remove power head, lift handle.

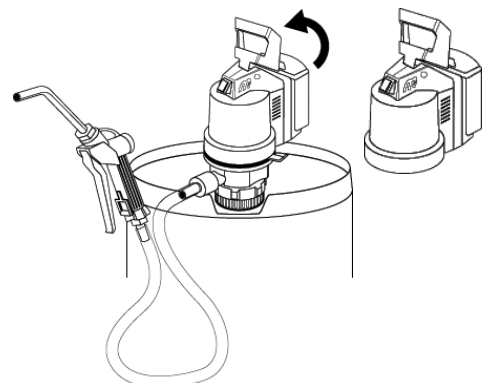

OPERATING INSTRUCTIONS

OPERATION



CAUTION

NOTE: Do not allow the pump to run dry or pump damage can occur

IMPORTANT:

For initial operation

- 1) Turn slot in shaft clockwise with a flat head screwdriver
- 2) Turn on pump and press trigger to prime the pump
- 3) To stop flow release trigger

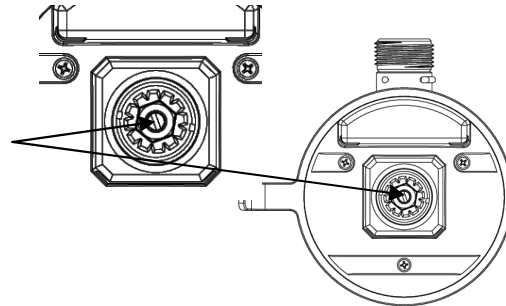

Note:

Pump will not run when power head is not attached to pump stem correctly

Pressure sensor will turn motor off when trigger is released and stall pressure is reached

- 3) Power head can be moved from pump assembly to pump assembly
- 4) Long storage periods :
 - a) Turn shaft 2 full turns counter clockwise using a flat head screwdriver.
 - b) When starting pump after a long storage period, turn shaft clockwise with a flat head screwdriver

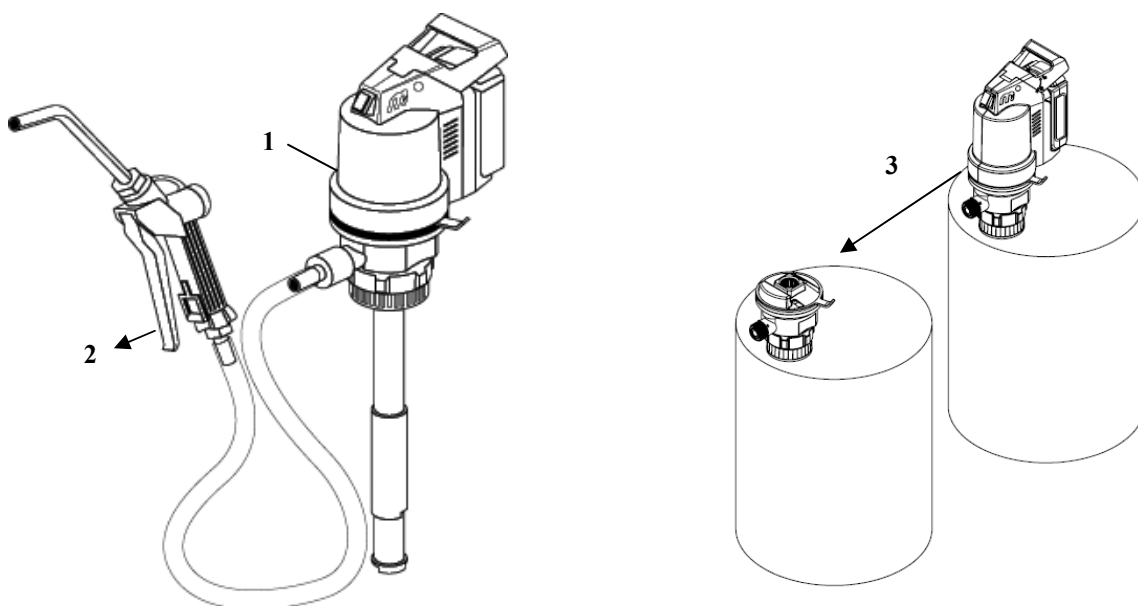

DIAPHRAGM AND SPRING REPLACEMENT

1) Turn anti-clockwise, remove drive gear

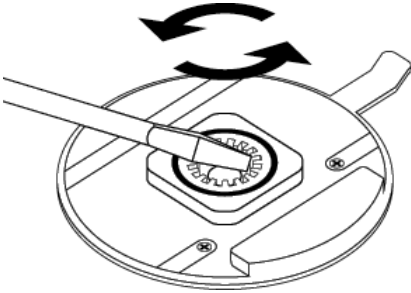

2) Remove 3 screws, pump cover and dispensing gun hanger

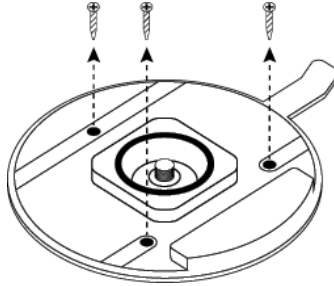

3) Remove 2 screws.

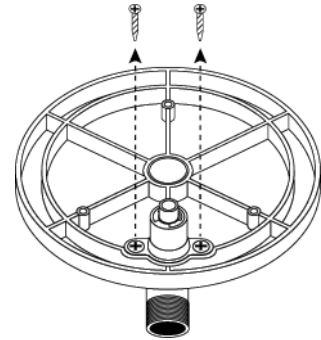

4) Remove assembly.

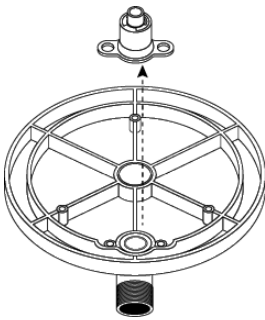

5) Remove circlip.

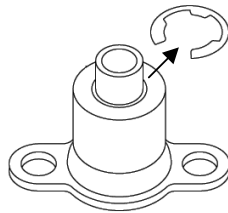

6) Replace spring.

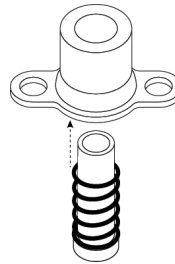

7) Re-fit circlip.

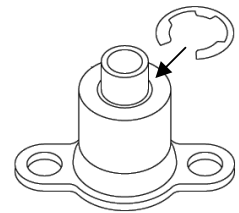

8) Remove old diaphragm.

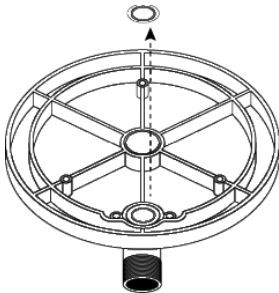

9) Fit new diaphragm. (ensure correct orientation)

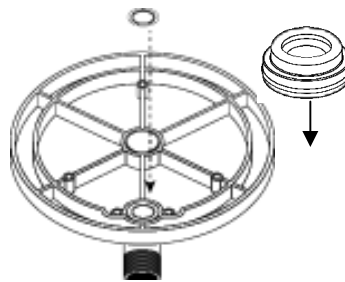

10) Fit valve switch assembly.

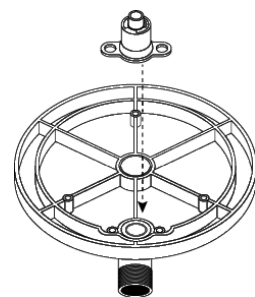

11) Fit 2 screws.

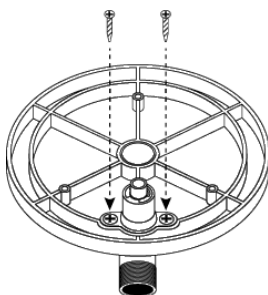

12) Fit pump cover and dispensing gun hanger, using 3 screws.

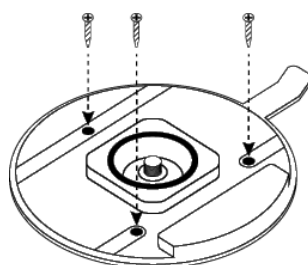

13) Fit drive gear, turn clockwise to secure.

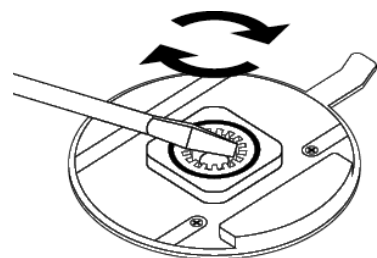

IMPELLER AND O’RING REPLACEMENT

1) Unscrew adapter

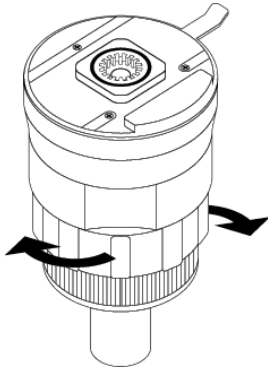

2) Remove o’ring.

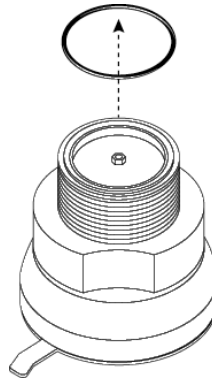

3) Remove impeller housing.

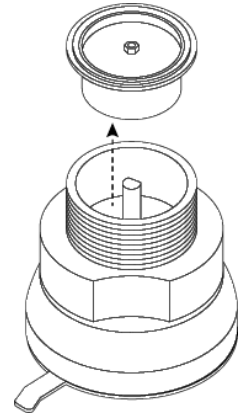

4) Remove o’ring.

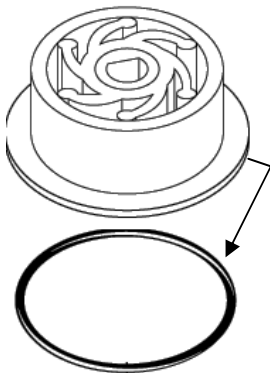

5) Carefully remove and replace impeller.

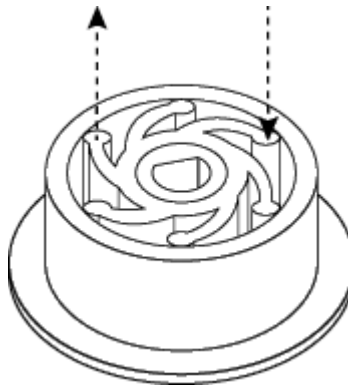

6) Replace o’ring.

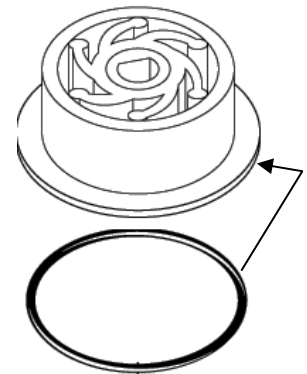

Note: Impeller must be lubricated with oil or grease during assembly.

7) Carefully insert impeller housing.
(Note correct orientation of grooves)

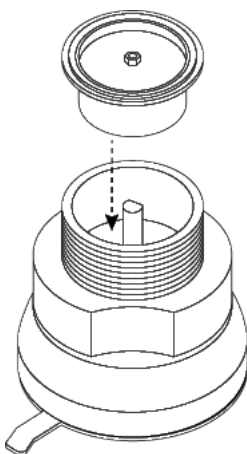

8) Replace o’ring.

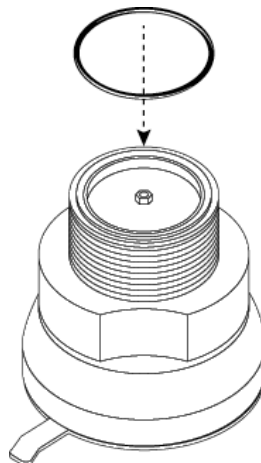

9) Firmly hand tighten pump tube.

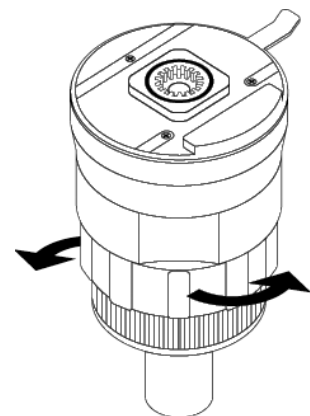

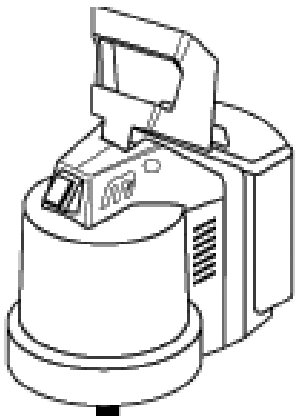

EXPLODED DIAGRAM

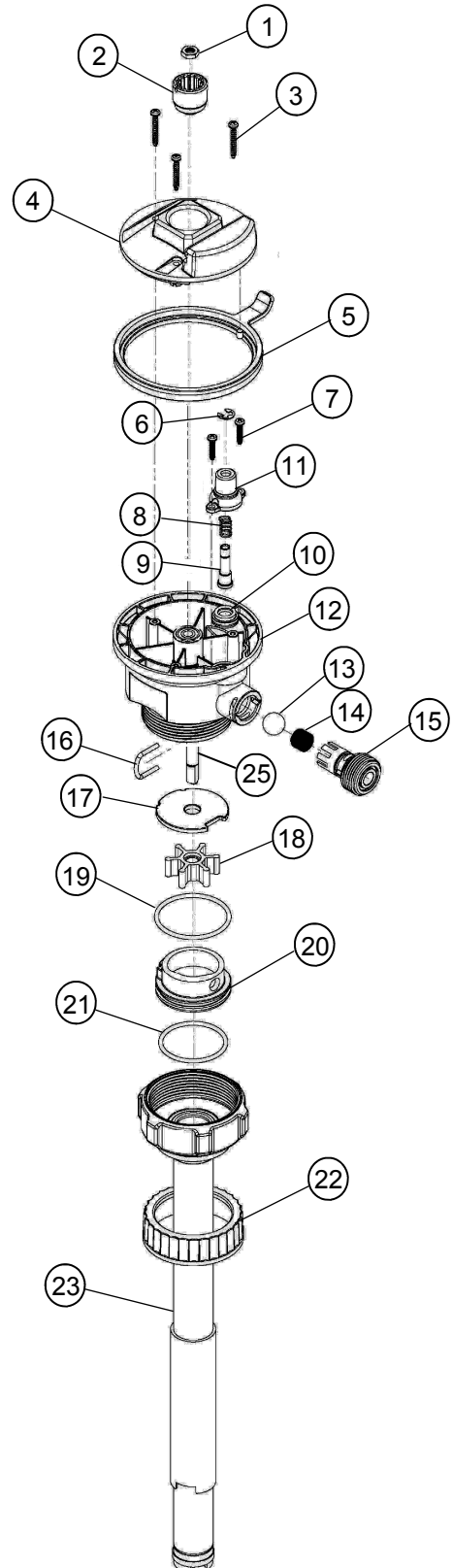

Note: Power head is factory sealed and would need to be replaced if found to be damaged internally or externally.



Spare parts list

Item no	Kit Ref	No off	Description
BOP20-1K	A		Pump Seal Kit
1		1	Nut (M6)
2		1	Connector
3		3	Screws (3.5 x 25)
4		1	Top pump stem cover
5		1	Dispensing gun hanger
6	A	1	Circlip
7		2	Screws (3.6 x 16)
8	A	1	Spring
9	A	1	Plunger
10	A	1	Diaphragm
11		1	Pressure switch housing
12		1	Housing - pump stem
13		1	Ball
14		1	Spring
15		1	Connector (outlet body)
16		1	U-Clip
17	A	1	Impeller cover
18	A	1	Impeller
19	A	1	O'ring
20	A	1	Impeller housing
21	A	1	O'ring
22		1	Bung adapter (type C)
23		1	Suction tube assembly
24	BP-HG	1	Gun and hose set (not shown)
25		1	Drive shaft

Parts listed (A) included in BOP20-1K seal kit

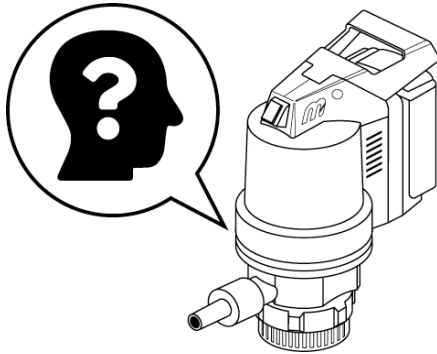
TROUBLESHOOTING GUIDE

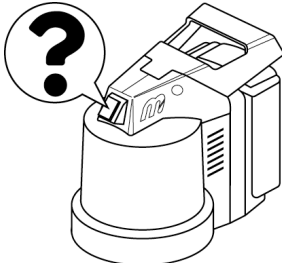
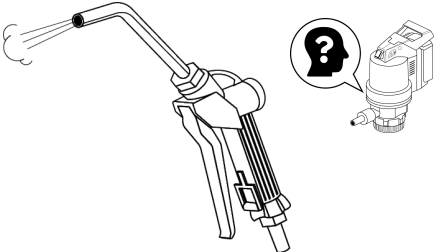

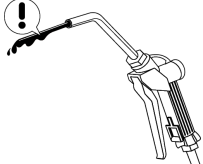
TROUBLE	CAUSE	REMEDY
<p>Pump does not turn on</p> 	<ul style="list-style-type: none"> a) Flat battery b) Power head not attached correctly to pump c) Faulty switch d) Pump stem failure 	<ul style="list-style-type: none"> a) Recharge battery b) Re-fit power head correctly c) Contact supplier d) Contact supplier
TROUBLE	CAUSE	REMEDY
<p>Pump will not prime</p> 	<ul style="list-style-type: none"> a) Pump tube plug has not been removed before use. b) Damaged or worn impeller c) No oil in container d) Damaged gun e) Damaged diaphragm 	<ul style="list-style-type: none"> a) Remove tube plug b) Fit new impeller Note: Do not let the impeller run dry c) Check oil level in container d) Replace gun c) replace diaphragm
TROUBLE	CAUSE	REMEDY
<p>Power head does not stop when gun trigger is released</p> <ul style="list-style-type: none"> a)  b) c)  	<ul style="list-style-type: none"> a) Damaged diaphragm or spring b) Damaged or worn impeller c) Gun leaking 	<ul style="list-style-type: none"> a) Replace damaged diaphragm or spring b) Replace impeller c) Replace gun



SPECIFICATIONS

Voltage DC	18 Volt Li-Ion Battery
Flowrate	3.5 l/min (0W-40 @ 20 deg C)
Operating Temperature	0°C - 40°C (32°F - 104°F)
Drum Size	20ltr
Fluid compatibility	Automotive oils / Lubricants
Max Viscosity	SAE90
Self Priming	Yes
Shut off Pressure	20psi
Hose	12.5mm x 1.5m (5ft) wire reinforced PVC
Warranty - Pump and Power Head	2 Years
Warranty - Battery	12 Months
Wetted components	Nitrile rubber, Mild steel, Stainless steel, Nylon, Brass, Polypropylene, Zinc plated steel

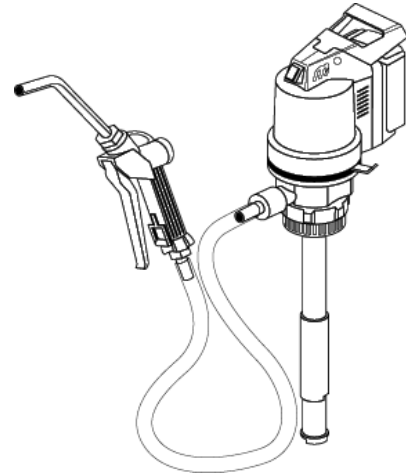

Macnaught Pty Limited
ABN 66 000 075 785

41 - 49 Henderson St
Turrella, NSW, 2205
Sydney, Australia.

Postal Address PO Box 90
Arncliffe NSW 2205 Sydney,
Australia.

T. +61 2 9567 0401
F. +61 2 9597 7773
W. www.macnaught.com.au

Note:

This product should be disposed of according to all applicable local and national government environment regulations and guidelines.



For Warranty Terms and Conditions see macnaught.com.au
For a list of Australian Service Centres see macnaught.com.au