

Isuzu D-Max (feb2017-jul2020) 3.0L Turbo Diesel 4Cyl. DOHC 4JJ1-TCX

OS-PROV-25



**MANN Provent 200 IV Oil Catch Can Kit Install Guide**

**CAUTION: \*\* Ensure the engine is OFF & COOL before installation ! \*\***

SCAN QR-CODE To View Install Slide Presentation >

- STEP 1:** Remove Engine Cover. Identify Install Area.
- STEP 2:** Release the Nut holding the DPF Sensor Switch to the bracket. Remove the OEM Bracket.
- STEP 3:** Swivel Provent's position within it's plastic bracket, 4 clicks anti-clock wise. Attach the Clear Drain Hose to the Base of the Provent. Secure with clamp & tighten
- STEP 4:** Fit the supplied Bracket where the OEM bracket had been. Secure the DPF Sensor Switch.



**STEP 1:**

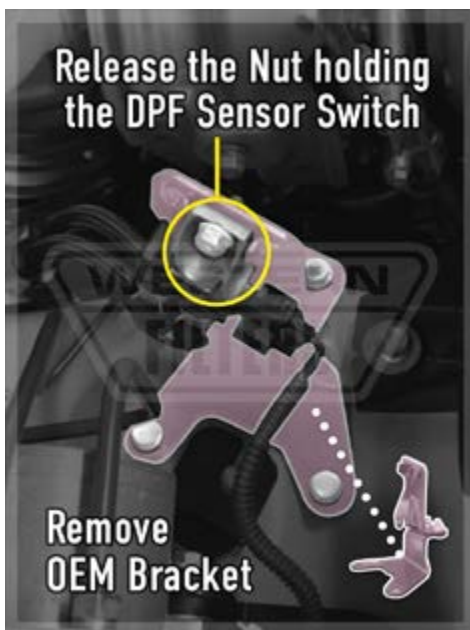

**STEP 2:**



**STEP 3:**

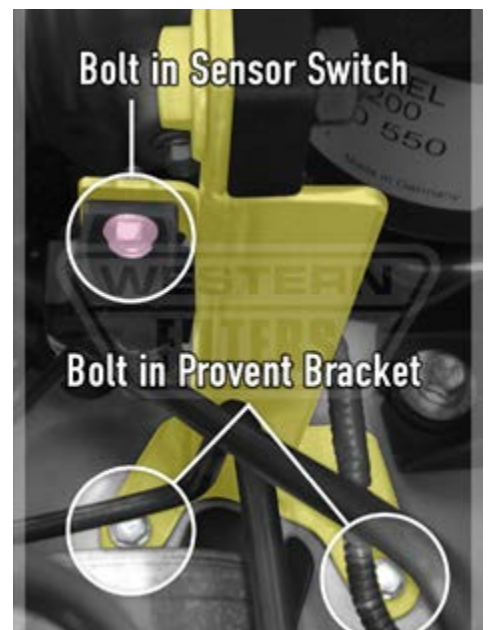

**STEP 4:**

Isuzu D-Max (feb2017-jul2020) 3.0L Turbo Diesel 4Cyl. DOHC 4JJ1-TCX

OS-PROV-25

**STEP 5:** Feed the Drain Hose down through the bottom of the engine bay, down the side of the chassis rail and along the Wheel Arch. Trim the Drain Hose to the desired length. Insert the Drain Tap. Secure with Clamp.  
**\*\* Ensure Tap is CLOSED \*\***  
Cable tie where necessary.

**STEP 6:** Fit Provent 200 to the supplied Bracket.

**STEP 7:** Remove the 'S-shaped' Breather hose from between the Crankcase Outlet and the Air Intake. Take the supplied Shorter 'J-Type Hose' and Connect the flanged end of to the Provent's Lower Outlet. Connect the other end to the Air Intake hose fitting (found in front of the Turbo, beneath the OEM-Orange Turbo Hose).

**STEP 8:** Connect the flanged end of the supplied Longer moulded hose to the Provent's Top Inlet. Connect the other end to the Crankcase's Outlet. Secure with supplied hose clamps.

**STEP 9:** Cable tie hoses to avoid rubbing where necessary. Return engine cover. kit installed.

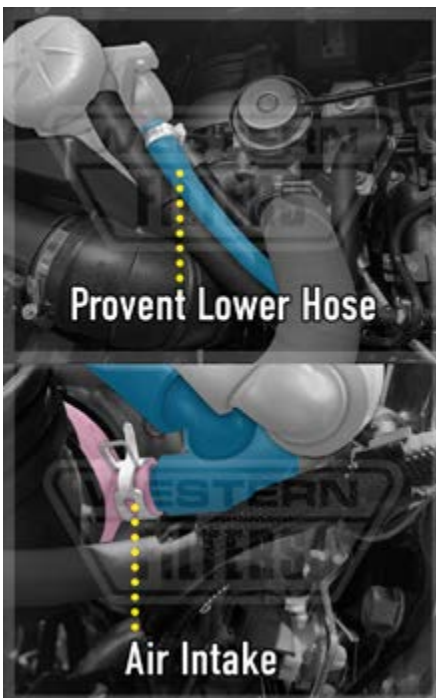
**STEP 5:****STEP 6:****STEP 7:****STEP 8:****STEP 9:**